

ACCESS & ROAD LAYOUT No.1 - AIRTON ROAD

SCALE @ A1: 1:100
SCALE @ A3: 1:200

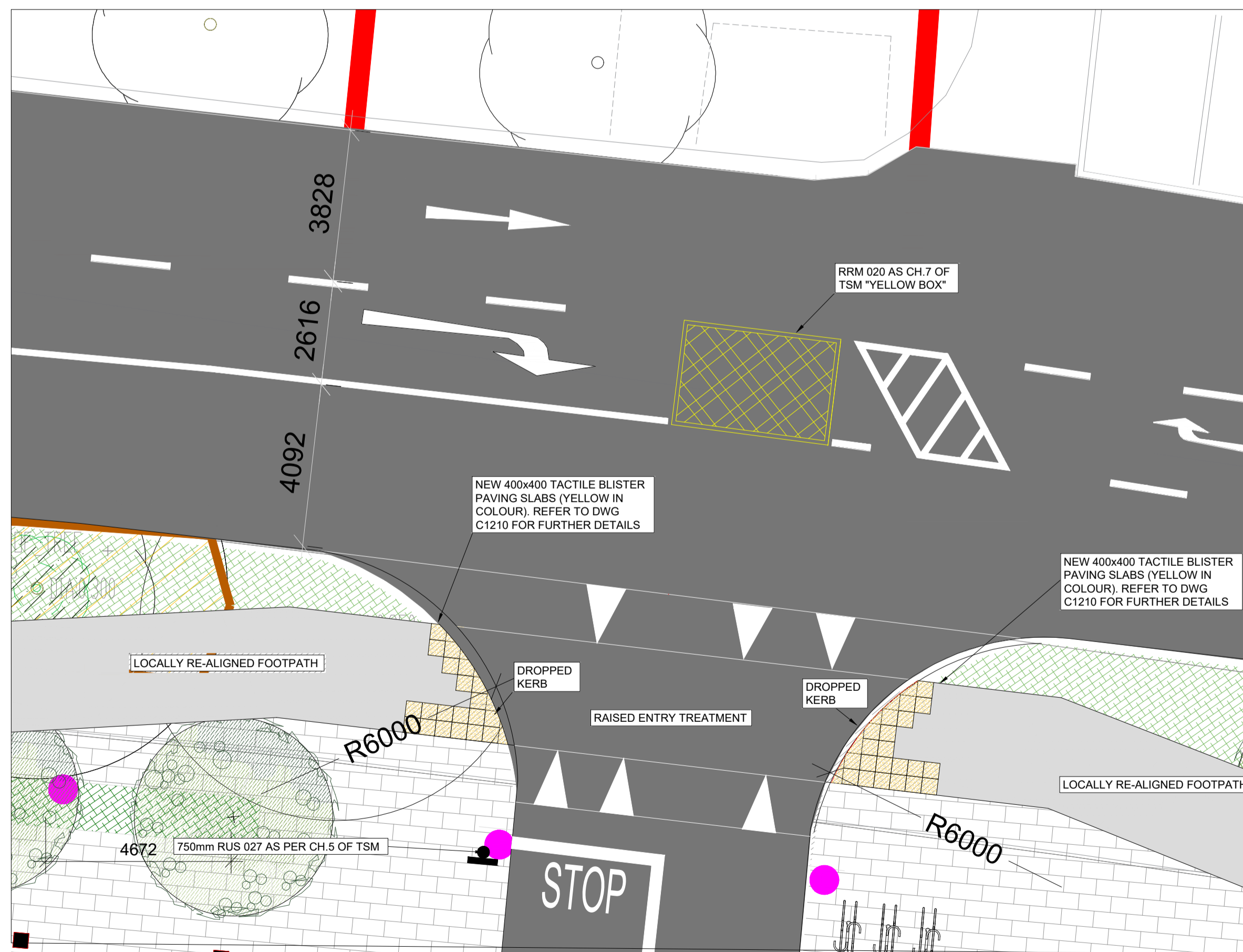

ACCESS & ROAD LAYOUT No.2 - AIRTON ROAD

SCALE @ A1: 1:100
SCALE @ A3: 1:200

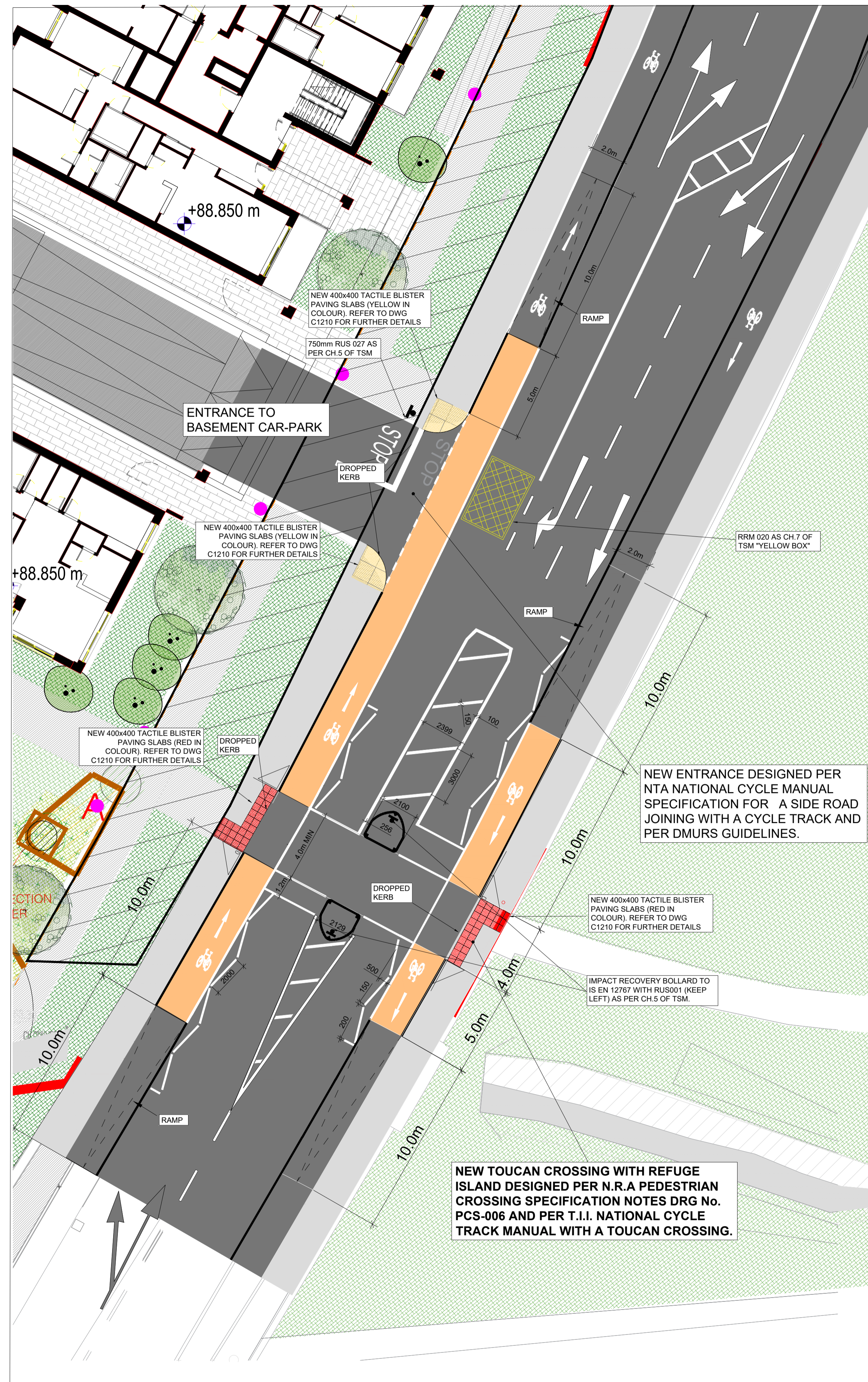

ACCESS & ROAD LAYOUT No.3 - GREENHILLS ROAD

SCALE @ A1: 1:150
SCALE @ A3: 1:300

NOTES

- THIS DRAWING IS TO BE READ IN CONJUNCTION WITH ALL ENGINEERS & ARCHITECTS DRAWINGS. FIGURED DIMENSIONS ONLY (NOT SCALING) TO BE USED. WHERE A CONFLICT OF INFORMATION EXISTS OR IF IN ANY DOUBT - 'ASK'.
- CONSULTANTS TO BE INFORMED IMMEDIATELY OF ANY DISCREPANCIES BEFORE WORK PROCEEDS.

PROPOSED LEGEND

- BUS CONNECTS ROUTE
- LAY BY FOR BINS / TAXIS / DELIVERIES
- YELLOW BOX
- ROAD SURFACE
- FOOTPATH SURFACE
- BIKE PARKING
- CAR PARKING
- SOFT LANDSCAPING / GRASS AREA

DK



"DK" DENOTES DROPPED KERB, i.e. 0-6mm UPSTAND. (NOTE KERBS TO FRONT OF PARKING/DRIVEWAYS SHALL BE LIMITED TO 25mm UPSTAND. STANDARD 125mm KERBS TO BE PROVIDED ELSEWHERE UNLESS OTHERWISE NOTED.)
DENOTES PROPOSED TRAFFIC SIGN ON NEW 76.1mm Ø CHS GALVANISED POST AND FOUNDATION

NOTE:
FOR THE PURPOSES OF EXPRESSING NEW ROAD LINE MARKINGS, THE EXISTING PUBLIC ROAD IS SHADED. NO RE-SURFACING OF PUBLIC ROADS WILL BE CARRIED OUT.

PL1	12.02.20	ISSUED FOR COMMENT	RM	RM	RM
ISSUE	DATE	DESCRIPTION	DRN	P.E.	P.D.

DRAWING STAGE **PLANNING**

BM Dublin Office: Sandwith House, 52-54 Lower Sandwith Street, Dublin 2, Ireland. Tel: (01) 677 3200 Fax: (01) 677 3164
London Office: 12 Mill Street, London SE1 2AY, United Kingdom Tel: (0044) 084 5413 2722
Consulting Engineers, Civil, Structural, Project Management. E-mail: bmce@bmce.ie Web: www.bmce.ie

ACEI The Institution of Structural Engineers

CLIENT **GREENLEAF HOMES LTD.**

PROJECT TITLE MIXED-USE DEVELOPMENT, THE FORMER GALLAHER SITE, AIRTON ROAD, TALLAGHT, D24	BM PROJECT No. 19.136
MODEL REFERENCE	MODEL REV. SUITABILITY

DRAWING TITLE **ENTRANCE DETAILS**

DRAWING No. ARD-BMD-00-XX-DR-C-1025	ISSUE PL1
-----------------------------------------------	---------------------